



## 24 Birch View

Wardle | OL12 9PZ



# 24 Birch View

Wardle | OL12 9PZ



## Overview

- Penthouse Apartment
- Two Bedrooms
- Open-Plan Lounge / Kitchen
- Juliette Balcony
- Three-Piece Bathroom
- Communal Gardens
- Ample Parking
- Service Charge - £344.60 P/Q
- Fixed Ground Rent - £250.00 P/A
- On The Cusp Of Wardle Village
- Vacant Possession



## Second Floor Two Bedroom Penthouse Apartment In A Popular Yet Convenient Location

Located on the cusp of Wardle village, this penthouse apartment is also on the doorstep of local transport links including bus routes and train station with regular regular services to Manchester & Leeds.



Internally, the secure apartment is located on the second floor of the building and comprises of an entrance hall, lounge / kitchen with Juliette balcony, two bedrooms and three-piece bathroom.

The apartment also benefits from having an electric heating system and upvc double glazing throughout.



The property has communal gardens and ample parking.

## Second Floor

Approx. 44.1 sq. metres (474.2 sq. feet)

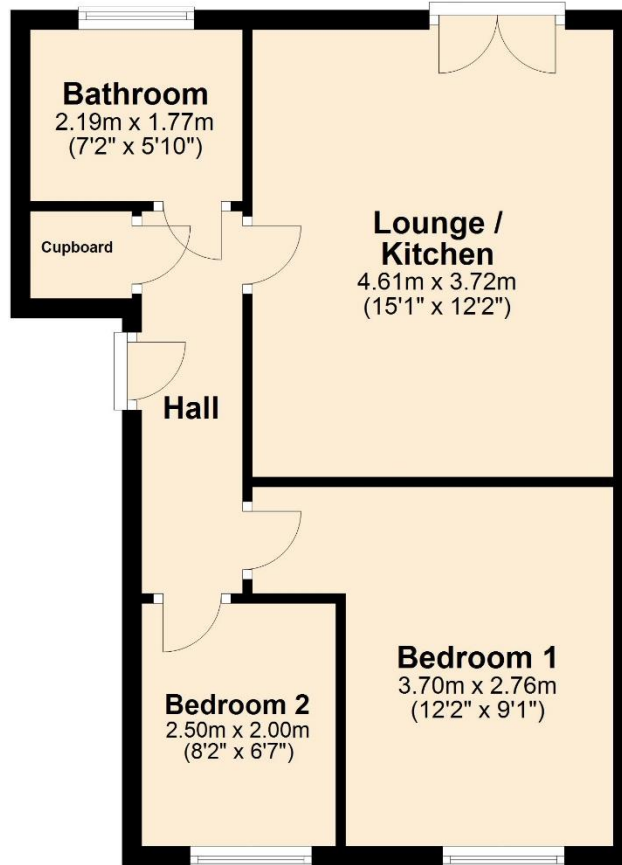

Total area: approx. 44.1 sq. metres (474.2 sq. feet)

Reside Estate Agency  
Plan produced using PlanUp.

4 Smith Street, Rochdale  
Lancashire, OL16 1TU

Tel: 01706 356633

Email: [enquiries@reside.agency](mailto:enquiries@reside.agency)

[www.reside.agency](http://www.reside.agency)

"Once you find the property you want to buy, you will need to carry out more investigations into the property than it is practical or reasonable for an estate agent to do when preparing sales particulars. For example, we have not carried out any kind of survey of the property to look for structural defects and would advise any homebuyer to obtain a surveyor's report before exchanging contracts. If you do not have your own surveyor, we would be pleased to recommend one. We have not checked whether any equipment in the property (such as central heating) is in working order and would advise homebuyers to check this. You should also instruct a solicitor to investigate all legal matters relating to the property (e.g. title, planning permission etc) as these are specialist matters in which estate agents are not qualified. Your solicitor will also agree with the seller what items (e.g. carpets, curtains etc) will be included in the sale".